



39 Westminster Road Leeming WA

4  2  2 

Welcome to 39 Westminster Road, a GEM LOCATION for families where a magnificent palm and established gardens privately frame this four bedroom, two bathroom home. Perfectly poised within short walking distance to Leeming Primary & High Schools, you can also get your "thirty a day" walking to and from Murdoch Train Station. An activity-sized, heated outdoor swimming pool beckons year round enjoyment and will be a family favourite area to spend time in.

Peaceful from the entrance porch heading into the hallway, you'll find a restful formal lounge and dining to your right, with a touch of old world charm in the beautiful jarrah floorboards, wall cornices and lighting. To your left, you'll love the storage space in the master bedroom, boasting a series of built in robes, generous walk in robe and bathroom ensuite.

Price : \$ 860,000
Land Size : 684 sqm
View : <https://www.thriverealestate.com.au/sale/wa/southern-suburbs/leeming/residential/house/6918113>



Derick Pitt
08 9414 9440

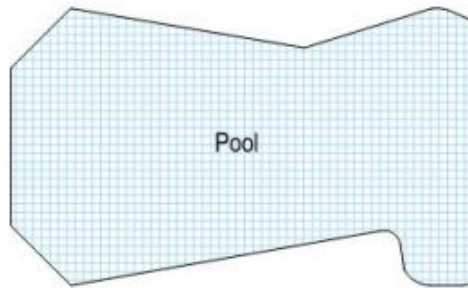

NOT IN POSITION

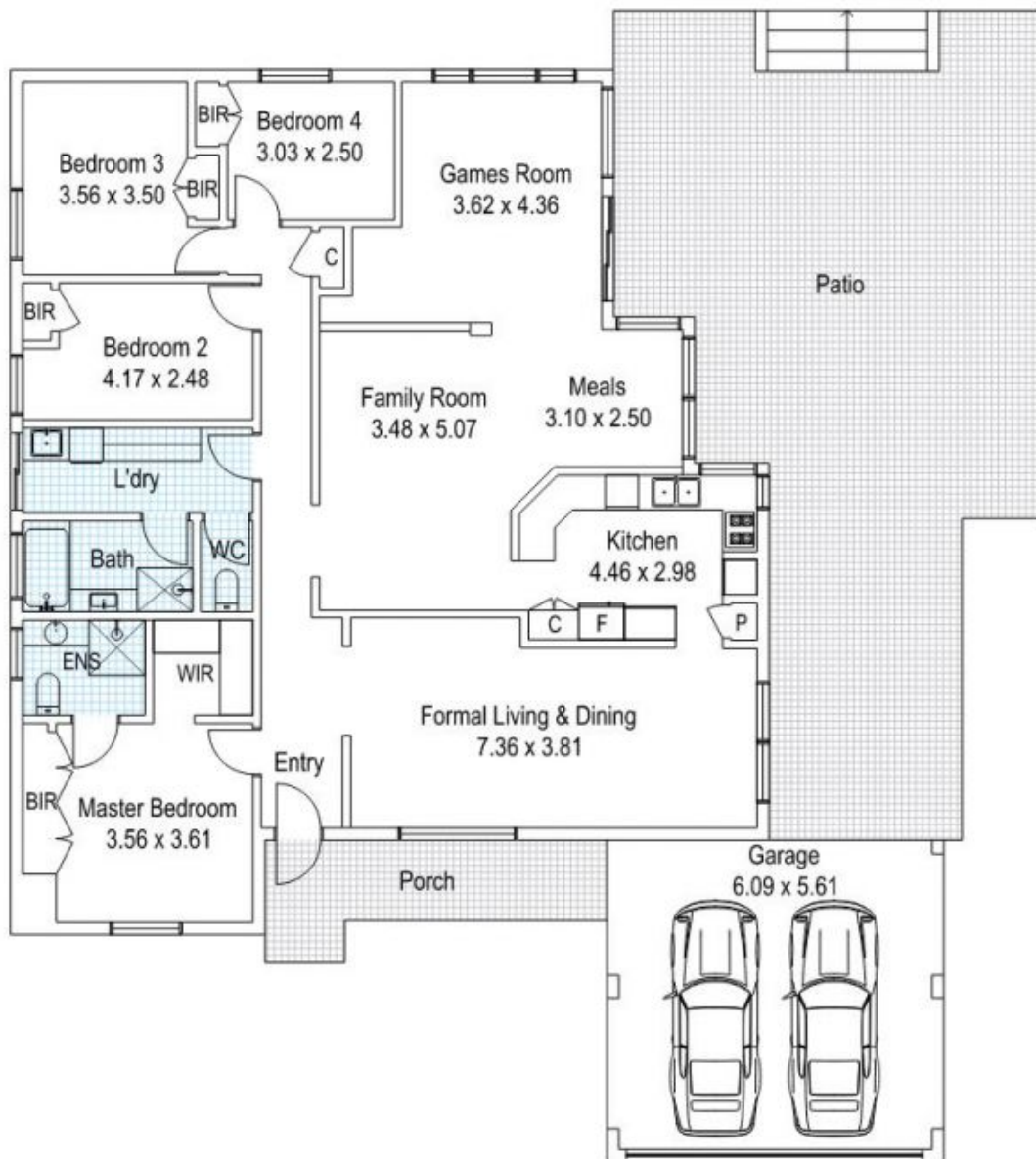

APPROXIMATE AREA:

Ground Floor: 184m²

Porch: 10m²

Patio: 85m²

Garage: 36m²

Total: 315m²



39
WESTMINSTER ROAD
LEEMING

INDICATIVE FLOORPLAN

Whilst every attempt has been made to ensure the accuracy of this floor plan, all measurements, and any other data shown are an approximate interpretation. Thrive Real Estate will not be held liable or responsible for any error, omission, mis-statement or use of any data shown on the final floor plan.